

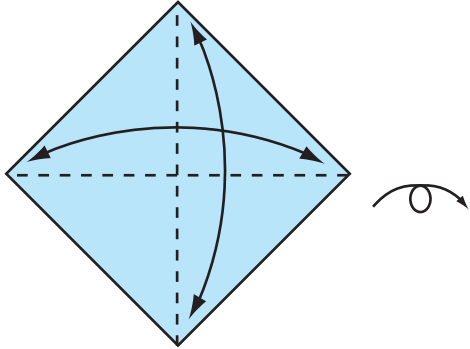

Origami Monkey and the Mountain

origami-fun
www.origami-fun.com



1. Start with a square piece of paper, coloured side up.
Fold in half in 2 directions

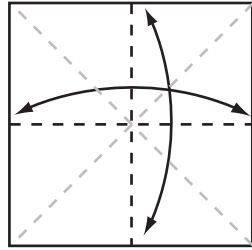

2. Turn the paper over to the white side.
Fold the paper in half, crease well and open, and then fold again in the other direction

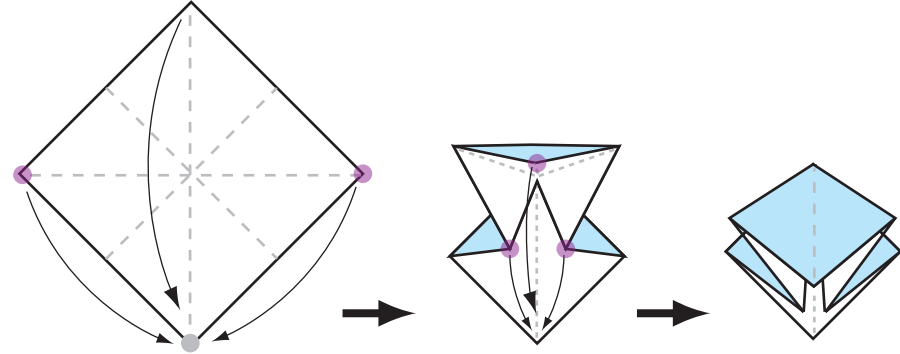

3. Using the creases you have made, Bring the top 3 corners of the model down to the bottom corner.
Flatten model

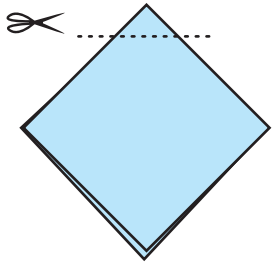

4. Cut the top of the model off: this is the monkey!!

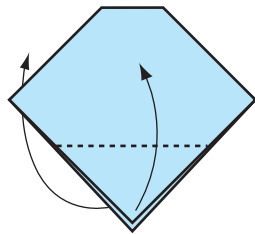

5. Fold uppermost flap upwards along the line shown. Repeat this step on the flap on the back of the model.

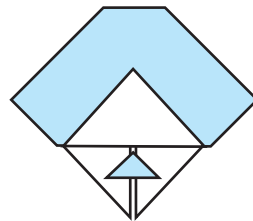

6. Now put the "monkey" in between the 2 bottom triangles.

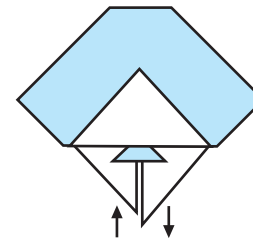

7. The monkey is ready to climb the mountain!
To get him to climb, move the bottom triangles up and down, keeping them together.

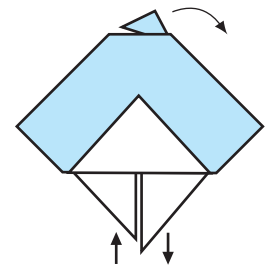

The monkey will climb all the way to the top if you keep shuffling the mountain... and then he pops out the top!